

CONCRETE / ASPHALT TRANSITION
SCALE: NO SCALE

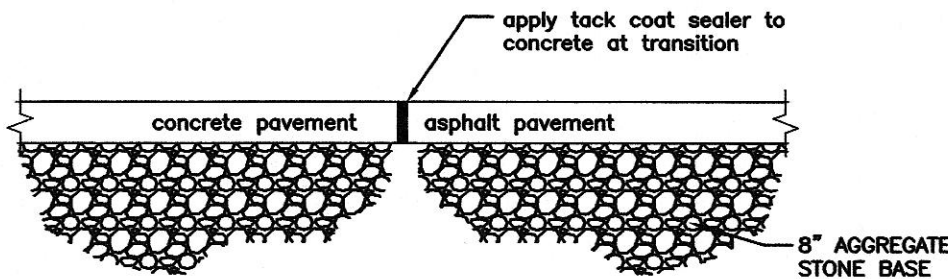

CONCRETE / asphalt pavement transition detail
n.t.s.

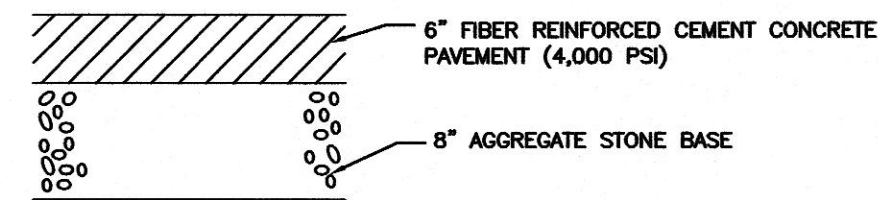

TYPICAL CONCRETE LOT PAVEMENT SECTION/ DUMPSTER PAD

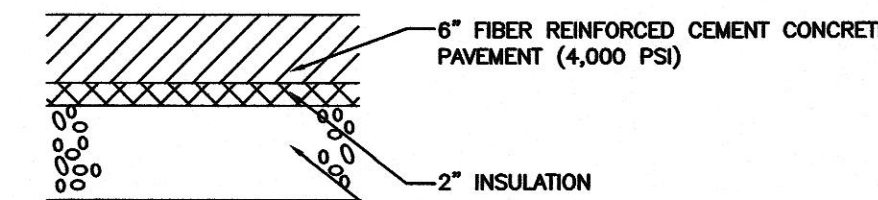

CARWASH ENTRANCE \ EXIT CONCRETE SLAB SECTION

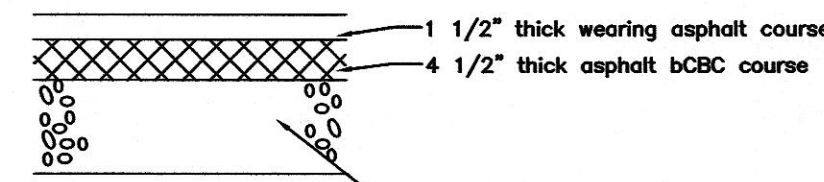

typical asphalt paving section

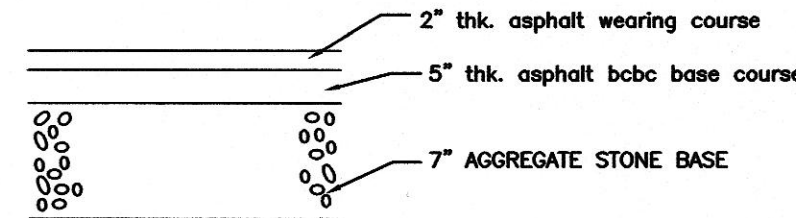

typical truck diesel asphalt paving section

GENERAL NOTES

- CONTRACTOR SHALL COORDINATE WORK WITH OTHER CONTRACTOR(S) ON-SITE.
- CONTRACTOR SHALL FIELD VERIFY VERTICAL AND HORIZONTAL LOCATIONS OF ALL UTILITIES PRIOR TO CONSTRUCTION. CONTRACTOR SHALL NOTIFY THE UTILITY COMPANIES 48 HOURS PRIOR COMMENCEMENT OF ANY CONSTRUCTION ACTIVITY. CONTRACTOR SHALL CONTACT MISS UTILITY (1-800-552-7001) 48 HOURS PRIOR TO COMMENCEMENT OF ANY CONSTRUCTION.
- CONTRACTOR SHALL NOTIFY VDOT PRIOR TO ANY CONSTRUCTION ON STREET RIGHTS-OF-WAY
- WHEN WORKING ADJACENT TO EXISTING STRUCTURES, POLES, ETC., CONTRACTOR SHALL USE WHATEVER METHODS THAT ARE NECESSARY TO PROTECT STRUCTURES FROM DAMAGE. REPLACEMENT OF DAMAGED STRUCTURES SHALL BE AT THE CONTRACTOR'S EXPENSE.
- EROSION AND SEDIMENT CONTROL NOTES:
 - ALL SEDIMENT CONTROL PRACTICES AND MEASURES SHALL CONFORM TO THE LATEST EDITIONS OF THE VIRGINIA EROSION AND SEDIMENT CONTROL HANDBOOK, THE 2016 VDOT ROAD AND BRIDGE STANDARDS AND THE 2016 VDOT ROAD & BRIDGE SPECS.
 - CONTRACTOR SHALL INSTALL SILT BARRIERS, INLET PROTECTION, CONSTRUCTION ENTRANCES AT POINTS OF INGRESS AND EGRESS TO PUBLIC RIGHT-OF-WAY, STABILIZE DISTURBED AREAS, AND PROVIDE OTHER MEASURES REQUIRED AS SHOWN ON THE DRAWINGS AND SPECIFIED, BY EROSION CONTROL ADMINISTRATOR.
 - CONTRACTOR SHALL TAKE ALL PRECAUTIONS NECESSARY TO PREVENT TRACKING ON EXISTING PAVEMENTS.
 - CONTRACTOR SHALL INSTALL GRAVEL CONSTRUCTION ROAD STABILIZATION OF ADEQUATE AREA TO ACCOMMODATE CONSTRUCTION VEHICLE PARKING, MATERIAL STORAGE, ETC. AT A LOCATION CONVENIENT TO THE INDIVIDUAL CONSTRUCTION AREAS AND CONSISTANT WITH THE CONSTRUCTION SEQUENCES.
 - ANY DISTURBANCE TO EROSION AND SEDIMENTATION CONTROL MEASURES BY OTHER CONTRACTOR(S) SHALL BE REPAIRED AND/OR REPLACED BY THE RESPONSIBLE PARTIES.
 - CONTRACTOR SHALL TAKE ALL PRECAUTIONS NECESSARY TO VERIFY LOCATION OF AND PREVENT DISTURBANCE OF ANY EXISTING UTILITIES IN WORK AREA, AND PROVIDE IMMEDIATE TEMPORARY SERVICE TO ANY DAMAGED UTILITIES.
 - ALL DISTURBED AREAS OUTSIDE OF PROPOSED PAVEMENT, CONCRETE, ARE TO BE MULCHED AND SEED PER THE BUILDINGS, ETC. SPECIFICATIONS WITHIN 7 DAYS OF ACHIEVING FINAL GRADES.
 - IF CONSTRUCTION SCHEDULE DOES NOT ALLOW PERMANENT SEEDING IN THE DATES SHOWN IN THE SPECIFICATIONS OR IF CONSTRUCTION IS TEMPORARILY HALTED FOR A PERIOD OF 21 DAYS OR LONGER DUE TO WEATHER, WINTER SHUT DOWN, ETC., CONTRACTOR SHALL INSTALL TEMPORARY SEEDING WITHIN 7 DAYS. WHEN PERMANENT SEEDING DATES CAN BE ACCOMMODATED, THE CONTRACTOR SHALL RESEED WITH PERMANENT SEEDING MIXTURES. ALL SEEDER AREAS, WHICH DO NOT PRODUCE A THICK, HEALTHY, DESIRABLE VEGETATIVE COVER, ARE TO BE RESEEDED AND MULCHED AS NECESSARY UNTIL ACCEPTABLE VEGETATIVE COVER IS ESTABLISHED. PRIOR TO RESEEDING WITH PERMANENT VEGETATION, ALL ESTABLISHED TEMPORARY VEGETATION IS TO BE REMOVED.
 - ANY CONSTRUCTION WITHIN THE RIGHTS-OF-WAY ARE TO BE IN ACCORDANCE WITH THE VDOT STANDARDS AND SPECIFICATIONS REGARDING MATERIALS, INSTALLATION, AND TESTING, UNLESS NOTED OTHERWISE IN THE CONTRACT DOCUMENTS.
 - ALL TEMPORARY EROSION AND SEDIMENT CONTROL MEASURES TO BE REMOVED WITHIN 30 DAYS AFTER FINAL SITE STABILIZATION OR AFTER MEASURES ARE NO LONGER NEEDED, UNLESS OTHERWISE AUTHORIZED BY THE LOCAL PROGRAM ADMINISTRATOR.
 - EACH LAYER OF ALL GRADED AREAS AND EMBANKMENTS, CONSTRUCTED BELOW THE TOPSOIL LAYER, SHALL BE CONSTRUCTED PER THE GEOTECHNICAL RECOMMENDATIONS DETAILED IN THE SUBSURFACE INVESTIGATION REPORT AND OTHER CONTRACT DRAWINGS. GENERALLY, COMPACTION OF COHESIVE SOILS SHALL BE ACCOMPLISHED BY ROLLERS OR MECHANICAL TAMPERS AND COMPACTION OF GRANULAR MATERIALS SHALL BE ACCOMPLISHED BY RUBBER-TIRE ROLLERS OR VIBRATORY

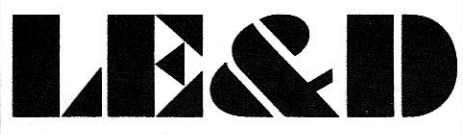

PROFESSIONALS, P.C.
RIVER RUN EXECUTIVE OFFICES
SUITE-B
110 EXCHANGE STREET
DANVILLE, VA. 24541

N.C. LICENSE: # C-2577
VA. LICENSE: # 0404-001401

PHONE NO. (434) 792-3680
FAX NO. (434) 792-3685

www.landeng.com

PROPOSED SHEETZ STORE
SHEETZ INC
CORNER OF EAST KING STREET AND NEW MARKET

SHEETZ DETAILS

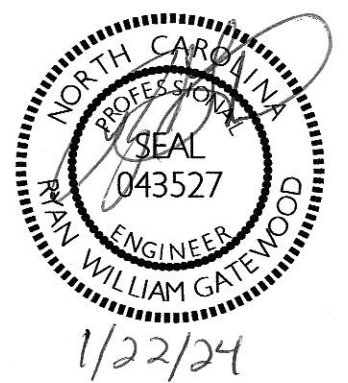

REVISED	NO.	DATE	DESCRIPTION	BY
1	6-23		TOWN OF BOONE	
2	7-20-23		TOWN OF BOONE	
3	1-22-24		ISSUE FOR CONSTRUCTION	

Sheet No. **19** of **25**
Date: MARCH 29, 2023
Scale: 1" = 20'
Project No.
NC122-010-B095engdwgF-22010-PLAN-I-REV-2



- ☐ FOR CONSTRUCTION
☒ FOR BID
☐ FOR REVIEW
☐ CONCEPTUAL

Issued 01/22/2024